



## HISTORIC ELMWOOD Foundation

*Where Detroit's History Endures*

### Historic Elmwood Foundation Board of Directors

Terry P. Book  
*President*

James Deutchman  
*Vice President*

John S. Snyder  
*Treasurer*

Reverend Steven J. Kelly  
*Secretary*

Elizabeth Thurber Crawford

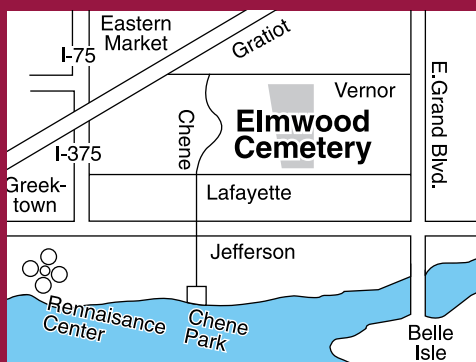

1200 Elmwood Avenue  
Detroit, Michigan 48207  
Phone: 313-567-3453  
Fax: 313-567-8861  
[www.elmwoodhistoriccemetery.org](http://www.elmwoodhistoriccemetery.org)

**Cemetery Grounds Access**  
8:30am - 4pm, Daily (Sept.-April)

**Office Hours**  
Mon - Fri: 9am - 4pm  
Sat: 9am - noon

# 2017 **FALL** Newsletter

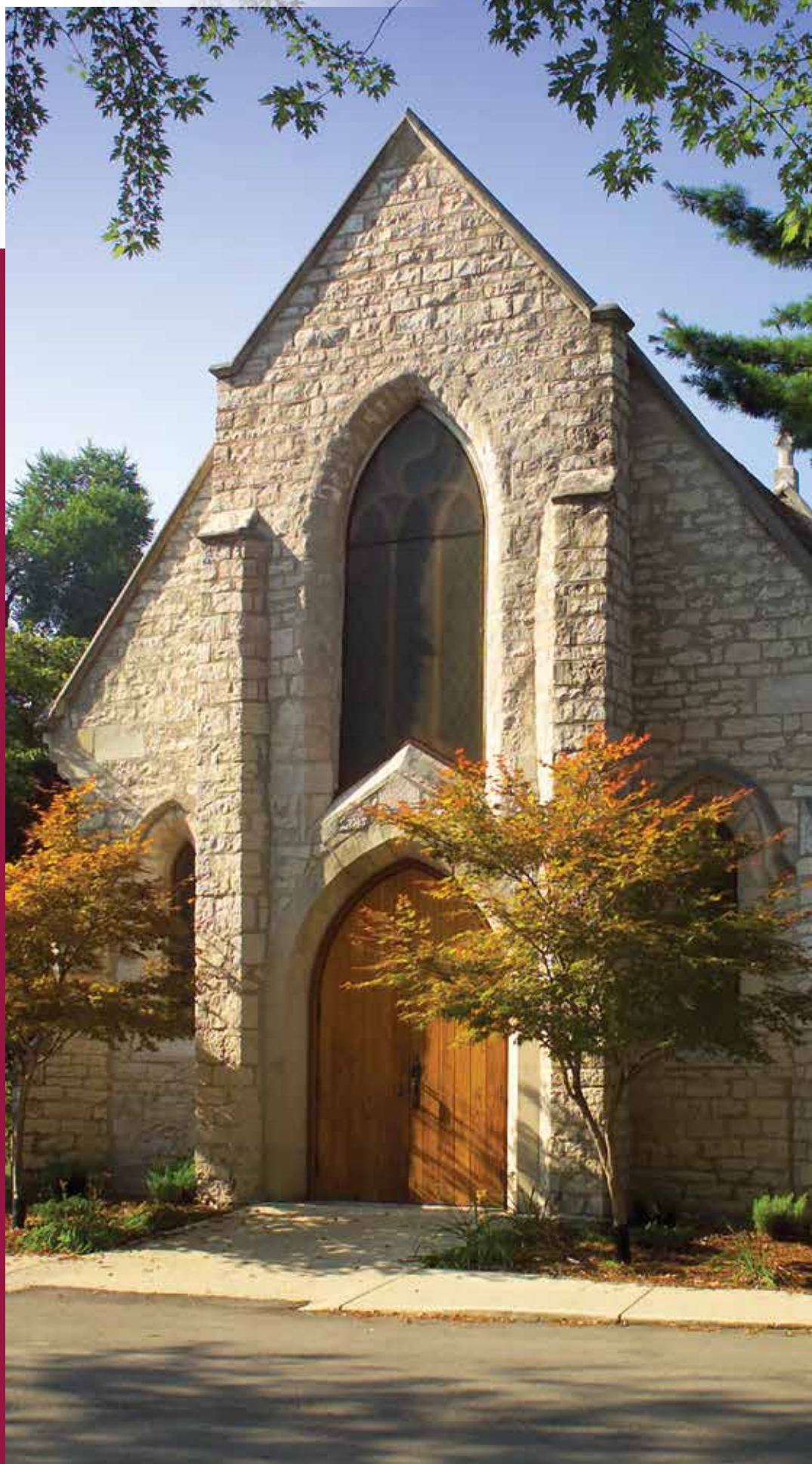



# Come Experience Elmwood's Great Fall Color!



The Historic Elmwood Foundation is excited to announce its development of self-guided tree tour maps for Detroit's first certified arboretum. Elmwood is proud to have over 100 species of trees and bushes. Three separate maps highlight varying species of trees across our 86 acres. These educational tools are designed to permit visitors to walk along our pathways to see the varying bark and leaf design, as well as flowers and buds, and learn the types of trees. The trees

highlighted on the maps each have a tree identification marker that has the scientific and common name, and a QR code. If you have a smart phone you can use this code to find out more facts about the species.

The self-guided Tree Tour maps are available, free of charge, in the lobby of the gatehouse, along with other educational material. They also are available to download from Elmwood's website, [www.elmwoodhistoriccemetery.org](http://www.elmwoodhistoriccemetery.org).

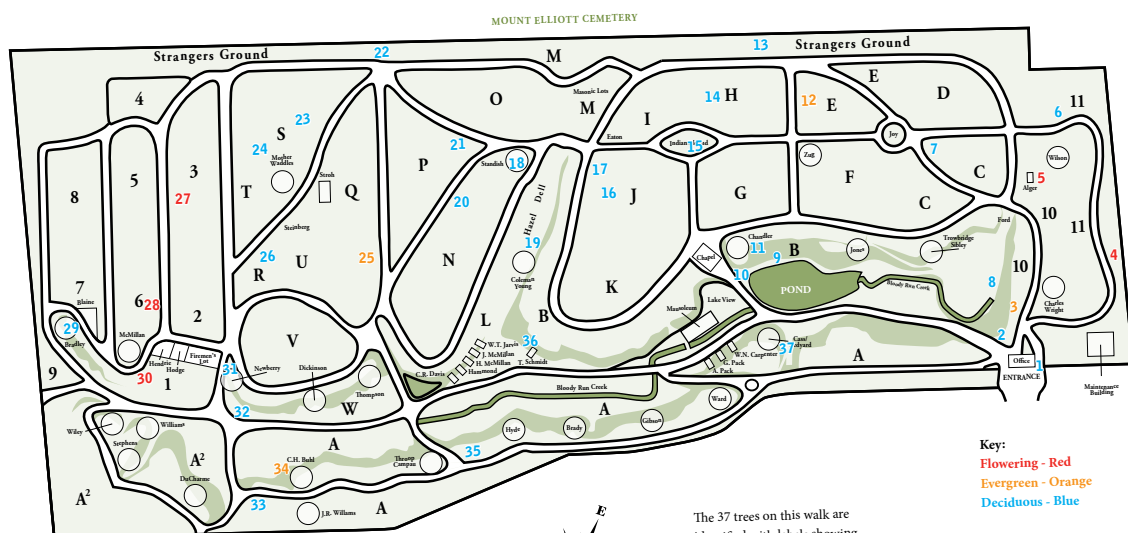

## TREE TOUR Northern Sections

1. European Beech
2. Paperbark Maple
3. Anglo-Japanese Yew
4. Apple
5. Apple Serviceberry
6. Kentucky Coffeetree
7. Amur Corktree
8. Sycamore Maple
9. Golden Raintree
10. Mulberry
11. Siberian Elm
12. Eastern Red Cedar
13. Sassafras
14. Hackberry
15. Horsechestnut
16. Pignut Hickory
17. European Hornbeam
18. Red Maple
19. Higan Cherry
20. Winter King Hawthorn
21. Northern Catalpa
22. Northern Pin Oak
23. Big-Leaved Linden
24. Freeman Maple
25. White Spruce
26. Southern Catalpa
27. Japanese Tree Lilac
28. Kousa Dogwood
29. English Oak
30. Tuliptree
31. White Oak
32. Swamp White Oak
33. Black Walnut
34. Douglas-Fir
35. Red Oak
36. Bur Oak
37. Cottonwood

Key:  
Flowering - Red  
Evergreen - Orange  
Deciduous - Blue

The 37 trees on this walk are identified with labels showing the common and botanical names. There are also QR codes for visitors with smart devices.





## Enjoying Elmwood

### Upcoming Birding Events

**Wednesday, September 20, 5:30 p.m.**

*Rain Date September 21, 5:30 p.m.*

**Friday, September 22, 9 a.m.**

**Thursday, October 12, 8 a.m.**

**Friday, October 13, 9 a.m.**

**Saturday, November 4, 9 a.m.**

**Saturday, December 2, 9 a.m.**

## Birding

Birding at Elmwood has grown significantly during the past three years. Our partnerships with Detroit Audubon Society and Rosann Kovalcek of Wild Birds Unlimited and the Michigan Audubon Society have brought hundreds of new visitors to Elmwood.

Please join us to see our native birds and those migrating south for warmer weather.



## Winter Grave Wreaths Available October 1

Honor your loved one with a winter wreath made of natural, freshly cut evergreen boughs with an all-weather red ribbon bow and 5 pine cones. The 18" diameter wreath will be on a stand and placed at your loved one's gravesite. Weather permitting, placement begins on November 15<sup>th</sup>. Quantities are limited. Please call 313/567-3453 today.

### STAY CURRENT

Keep up with what is happening at Elmwood Cemetery by checking our website, [www.elmwoodhistoriccemetery.org](http://www.elmwoodhistoriccemetery.org)

### UPDATE CONTACT INFORMATION

Please notify [jcapuano@elmcem.org](mailto:jcapuano@elmcem.org) if your address, phone number or email changes.



Keep an eye on our website or send a message to [jcapuano@elmcem.org](mailto:jcapuano@elmcem.org) to be added to our email list to receive information about upcoming events.



# Fall Guided Tour Schedule

Established in 1846, Elmwood Cemetery contains the graves of many prominent men and women including civil war generals, 7 governors, 11 U.S. senators, 30 Detroit mayors, and countless business and community leaders. Come join us on a guided walking tour as we share the stories of Detroit and the people that helped shape our great city and contributed to advancement for our citizens and industry. Our walking tours are FREE and last about 2 hours. We do require advance registration by emailing [jcapuano@elmcem.org](mailto:jcapuano@elmcem.org). Please provide your name, date of your desired tour, and the number of guests. Joan will send you a confirmation email.

## History Tours

**Wednesday, September 27, 8:30 a.m.**

**Saturday, October 28, 8:30 a.m.**

**Thursday, November 2, 9:00 a.m. – a special one-hour walk prior to our All Souls' Service**

## Fall Tree Tour

**Saturday, October 21, 8:30 a.m.**

*Self-guided tours are available in the office and through our website. Tours are also available through our partners – Detroit Historical Society, Charles H. Wright Museum of African American History, and Preservation Detroit.*

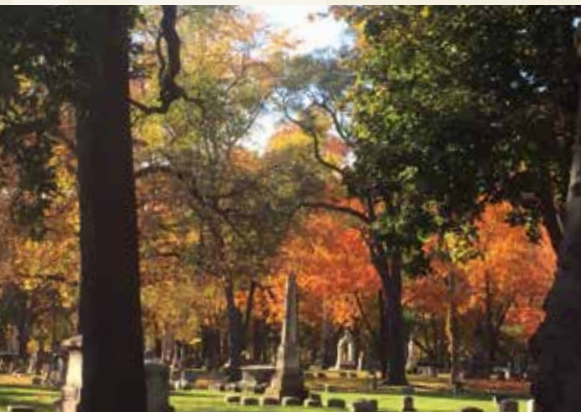

## Upcoming Events

The fall is a beautiful time to visit Elmwood Cemetery. Please keep these dates in mind for your fall activities:

### **All Souls' Service, November 2, 10 a.m., Chapel**

All are welcome to join the Elmwood community as Reverend Steven J. Kelly, pastor of St. John's Episcopal Church Detroit we remember and honor those who passed away in 2017. Light refreshments follow.

### **Veterans Celebration, November 10, 10 a.m., Civil War Section**

Members of Detroit area JROTC programs, Martin Luther King Jr. High School marching band, reenactors, community leaders, and most importantly, veterans come together for this 33rd annual commemoration of Veterans Day at Elmwood Cemetery.

*Please note the national observance of Veterans Day this year is on Friday.*



# 2017 Special Event Wrap Up



## Arbor Day

14 children from an area elementary school's 4<sup>th</sup> grade class celebrated at Elmwood this year. They learned about the history of Arbor Day, Elmwood's arboretum, and the importance of trees to the environment and the US economy. They planted a paper birch tree in section E and then toured the cemetery grounds. The students researched many remarkable people and then gave presentations at many gravesites.



## Firefighters Memorial Day Event

The Detroit Firefighters marched from the Mt. Elliott/Lafayette Firehouse to Elmwood accompanied by antique fire fighting equipment and the firefighter marching band. Over 100 attended this celebration.



## Schoolcraft College Photography Clinic

Nearly 40 young photographers participated in the Schoolcraft College sponsored photography clinic.



## Shady Ladies Literary Society

The inaugural event for the Shady Ladies Literary Society was held in June in the Black Walnut grove. This group was created by women who want to promote new authors by bringing them to Detroit to meet women and engage in good conversation.

The event, held in mid-June, highlighted two newer authors: Cristina Moracho, *A Good Idea* and Julie Buntin, *Marlena*. Also invited was Detroit's first Youth designated Poet Laureate, Hajjar Baban. The picnic style event began at 4 with a tour of the grounds and then a gathering in the grove where readings were conducted.

Food and beverages were catered by a number of newer Detroit restaurants. The Historic Elmwood Foundation thanks founder Amy Hameirl for her kind words: "Thank you so much for letting us host the first Shady Ladies event at Elmwood. It was so magical and everything I'd hoped. Everyone raved about your tour and I know Elmwood has many new fans and advocates. I hope we can do more together." We hope so too Amy!



*Everyone raved about your tour and I know Elmwood has many new fans and advocates. I hope we can do more together.*

– Amy Hameirl



# Your Support Matters

This past year, the generous donors to the Historic Elmwood Foundation provided educational and cultural opportunities for over 3,500 tour and event visitors. Elmwood's roadways were completely restored, our drainage system cleared, and the adjacent land leveled. We continued to care for and grow our arboretum and now have over 100 species in our collection. We expanded our educational programming with self-guided tree tour maps, and tree identification markers. We also offer tree identification tours with our partners at Greening of Detroit and local certified arborists.

Please help us ensure Elmwood Cemetery and Arboretum remains a sanctuary for all by donating to the Historic Elmwood Foundation today. An envelope is enclosed for your convenience. Historic Elmwood Foundation is a 501(c)(3) non-profit organization. Your donation is tax deductible to the extent of the law. If you are interested in making a bequest to Elmwood in your will, please contact Joan Capuano, Executive Director of the Foundation, on 313/801-1971.

Thank you for your continuing support of Elmwood.



## Our Mission:

To preserve the history and educational significance of Elmwood Cemetery and those laid to rest in the cemetery; and to develop social, cultural, and educational programs to benefit the community.

